

CHIEF XL

THE "CROWN JEWEL" OF THE
BRAUN AMBULANCE MODELS



This model provides the optimum in room, storage, and comfort.

Built on your choice of the Ford E- or F-450, Chevy G-4500, International TerraStar or Ram D-4500 chassis, you get a powerful vehicle with one of the highest usable payloads in the industry. The Chief XL SolidBody™ Construction boasts headroom height of 72" while taking advantage of the module's 169" length by providing maximum storage both inside and out. Available in the standard package or customized to meet your specific requirements, the Chief XL provides value, comfort, and safety for the patient and crew.

With the exclusive EZ Glide™ Sliding Door, safety and convenience are key advantages for your EMTs. By sliding the door out of the way, snug against the module, the door does not open into traffic or restrict personnel from entering

or leaving the module. Combined with the MasterTech™ Multiplex Electrical Control System and VitalMax™ Lighting System, the Braun Chief XL is the top choice of departments needing quality and reliability for today's ambulance services.

The Chief XL combines the advantages of an impressive module length, storage space, interior room, and high payload capacity in a Type I or Type III configuration. Exterior sides are lowered to offset the higher frame rail height of the F-Series, providing even larger storage capacity in the exterior compartments than even the Type III Chief XL. Interior headroom of 72" and the efficient use of space allow for exceptional roominess.



BRAUN
CUSTOM AMBULANCES
Built for Life

CHIEF XL



QUICK SPECIFICATIONS

	Ram D-4500	Ford E-450	Ford F-450	Chevy G-4500	Int'l TerraStar
Wheel Base	192	158	189	159	183
Overall Length	306.5	272.75	301.5	279	291
Overall Width	98	98	98	98	98
Overall Height	110	106.5	110	106.5	111
Module Length	169	169	169	169	169
**Module Width	**96	**96	**96	**96	**96
Module Headroom	72	72	72	72	72

***Add 2" for overall width to include the rub rails and exterior side warning lights.*

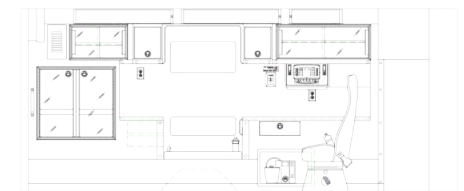
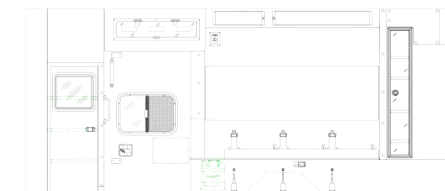
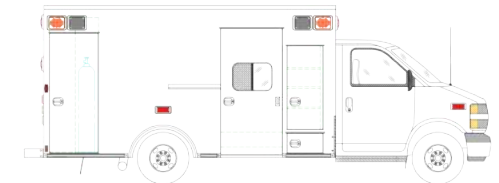

FEATURES & BENEFITS:

- Life-Time Transferable Structural Warranty | **Greater Value & Lower Life Cycle Cost**
- Braun's Exclusive SolidBody™ Construction | **Safety, Stronger Yet Lighter Module**
- Fully Welded-in Aluminum Interior Cabinetry | **Stronger & Lighter Weight**
- "Take The Edge Off" Rounded Interior Aluminum Cabinets | **Safety**
- Meganite Countertops | **High Quality, Better Aesthetics**
- Aluminum, One-piece Headliner | **Safety, Stronger & Lighter**
- EZ Glide™ Sliding Door | **Safety**
- VitalMax™ Lighting System | **Superior Shadowless Lighting**
- Eberhard Free Floating Latches | **Ease of Use & Maintenance**
- Anti-corrosion Package | **Prolonged Usage & Better Aesthetics**
- MasterTech™ Multiplex Electrical Control System | **Ease of Use & Maintenance**
- SealTite™ Doors | **Eliminates Weather & Road Debris Entering Compartment**
- Custom Aluminum Cab Console | **Fits Your Needs**

1170 Production Drive
Van Wert, OH 45891

Toll Free: 877-344-9990
www.BraunAmbulances.com

